

Rating:10A 250V AC (3C)
Contact Resistance: 50mΩ Max
Insulation Resistance: DC 500V 100MΩ Min
Dielectric Strength: AC2000V 1 minute
Electrical life: 10,000 cycles
Operating Temperature: 0°C ~ 85°C

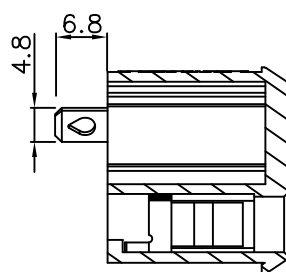

截面:A-A

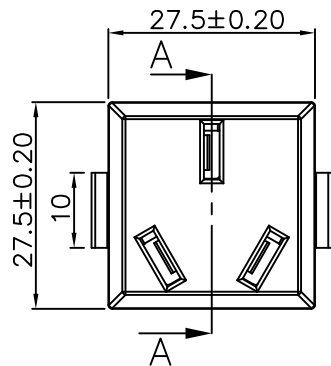
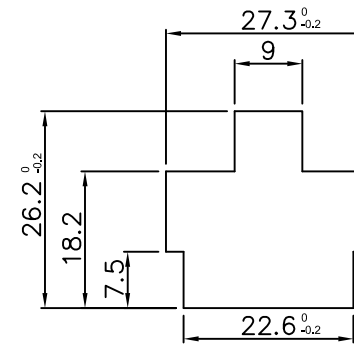
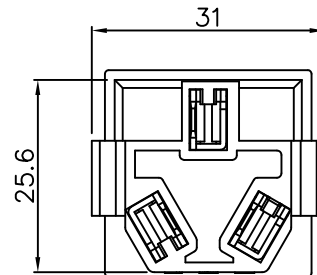

CUT-OUT

Panel Thickness:1~3mm

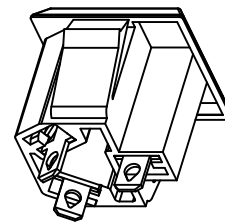
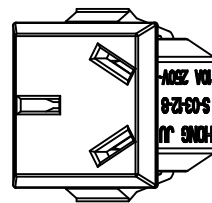
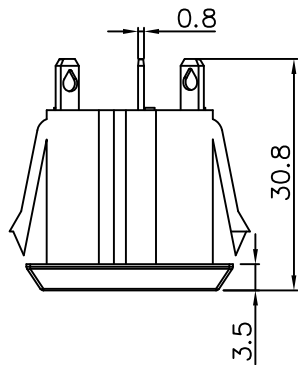

MATERIAL:
Body:PA66
Terminal:Brass silver or tin plated

		公差 TOLERANCES		.X± 0.3 .XX± 0.15		角度 ± 1°		单位 DIMENSION UNIT mm.	
		版本 VERSION	A0	比例尺 SCALE	NONE	日期 DATE	2020.06.19	品名 TITLE	图号 DRAWING NO
		核准 APPROVED BY		核对 CHECKED BY		绘图 DRAWN BY	Z. H. B.	S-03-12-8	S-03-12-8-A0
版本 VER.	变更说明 CHANGE DESCRIPTION	日期 DATE	ECN NO.	APPROVED BY	CHECKED BY	DRAWN BY			